

## 1002013 Damper Actuator Alignment Retrofit For Front Air Intake, Platinum 2.0 24V DC Cabinets

### Description

As part of Jamesway's continuous improvement process, an issue has been noted where the damper actuator on the 24V DC front air intake cabinets may become misaligned during installation, replacement or adjustment. This issue applies to both incubators and hatchers with the air intake located in the console housing.

The 1002013 kit has been issued to correct this potential issue and should be installed, at your convenience, on all affected front air intake cabinets.

### Procedure

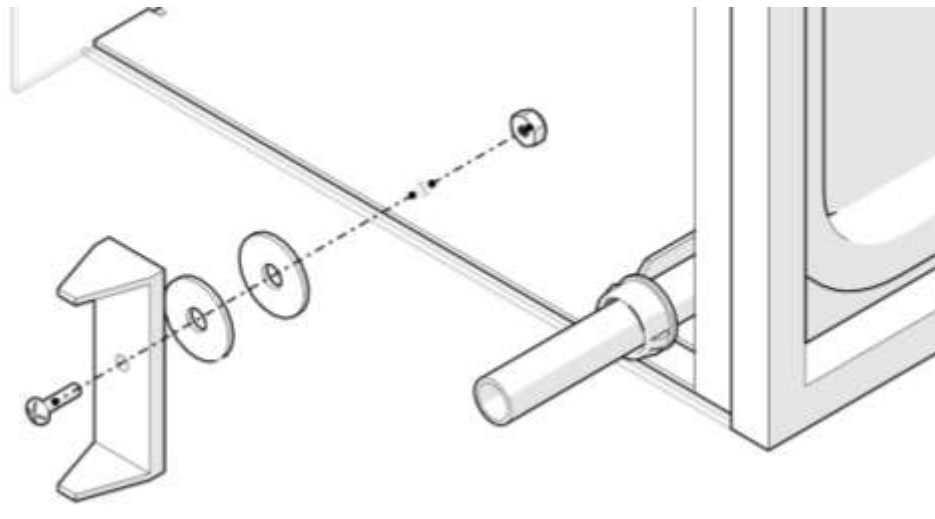

1. Remove the damper motor by loosening the clamp off the shaft and then unclipping the actuator.
2. Unplug the damper motor from the controls harness and inspect for damage. If damaged, contact Customer Service to order the actuator (1000013).
3. Remove the bracket from the housing and discard the screw.
4. Replace the bracket using the supplied machine screw, two of the nylon washers, and the locking nut on the inside of the intake housing.  
**Note:** Be careful not to overtighten the screw. The unit must remain square.
5. Replace the damper motor and ensure it is square to the shaft.